

KINDERGARTEN SCHEDULE (August 2017)

Sunday	Monday	Tuesday	Wednesday	Thursday	Friday	Saturday
		1	2	3 K-assessment (Rm. 9) & Parent orientation (MPR) – DAY 1 (I) 8:15 – 10:15 (II) 10:45 – 12:45	4 K-assessment (Rm. 9) & Parent orientation (MPR) – DAY 2 (I) 8:15 – 10:15 (II) 10:45 – 12:45	5
6	7	8 Class lists posted outside of office at 2:15 PM.	9 GROUP A 8:00 AM – 12:15 PM Juice & lunch will be served *Bring all labelled supplies including sleeping mat to school in a shopping bag. <u>Please do not put any supplies in the backpack.</u>	10 GROUP B 8:00 AM – 12:15 PM Juice & lunch will be served *Bring all labelled supplies including sleeping mat to school in a shopping bag. <u>Please do not put any supplies in the backpack.</u>	11 GROUP A 8:00 AM – 2:15 PM Juice & lunch will be served After school programs begin	12
13	14 GROUP B 8:00 AM – 2:15 PM Juice & lunch will be served After school programs begin	15 ALL STUDENTS 8:00 AM – 2:15 PM	16 ALL STUDENTS 8:00 AM – 1:30 PM	17 ALL STUDENTS 8:00 AM – 2:15 PM	18 HOLIDAY-NO SCHOOL	19

Please drop off and pick up your child at Room 9 (red doors wing) for Kindergarten Assessment. Please have your child wear covered shoes and comfortable clothing.

Parent Orientation will be held in the Multipurpose Room while your child is being assessed. (See map on back)

Manoa School

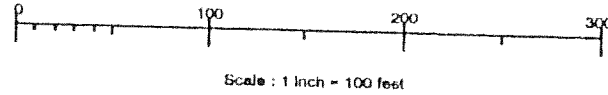

Manoa Road

Ø2

Parking

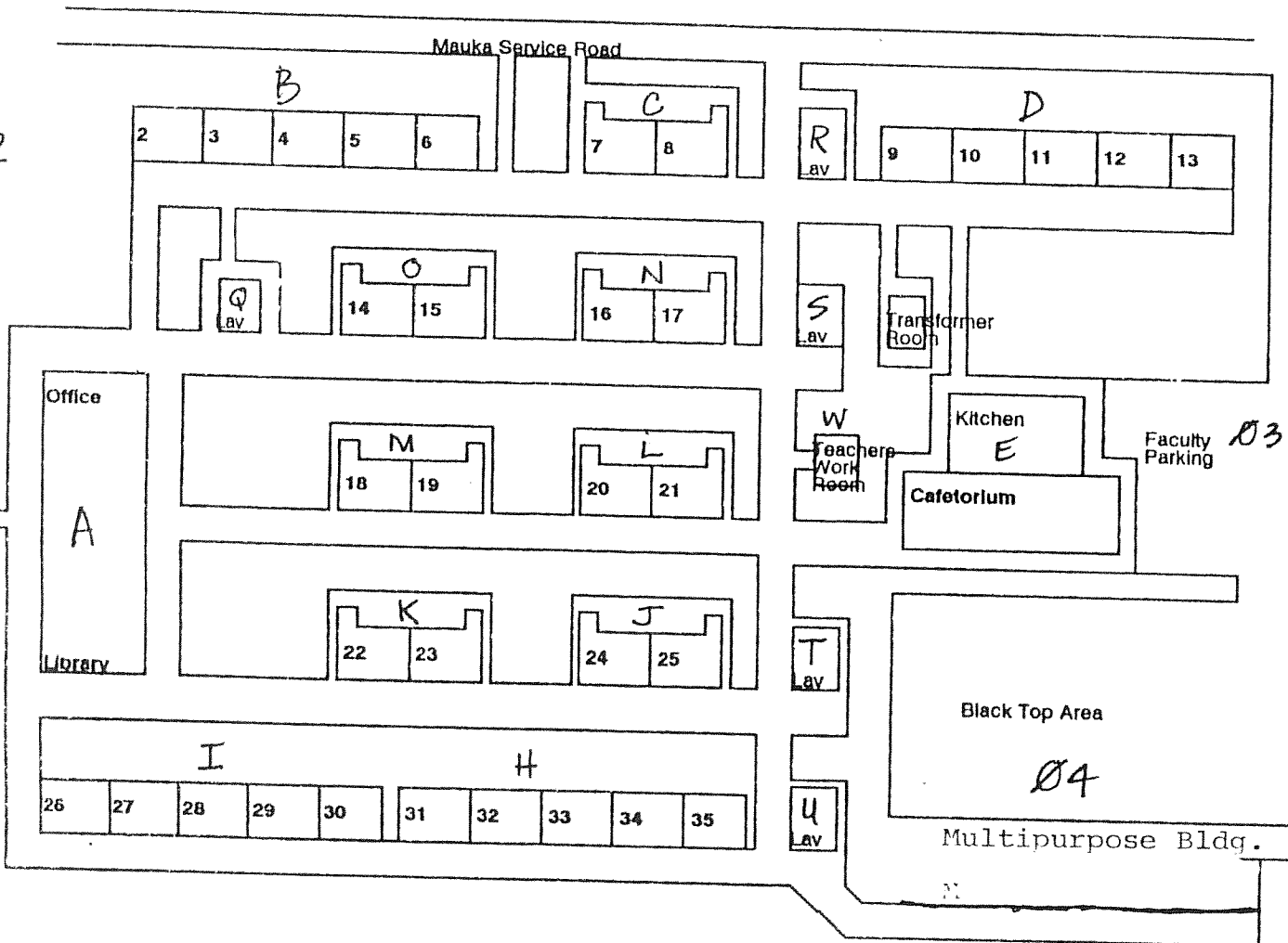

F - Scout Room

Kahaloa Drive

Ø7

Manoa Recreation Road